

**F.No-Exhi-02/2020/NGMA**  
**National Gallery of Modern Art**  
**Jaipur House**

27<sup>th</sup> January 2021

**TENDER NOTICE**  
**INVITATION FOR QUOTATIONS**  
**Sub: Exhibition- Hاستantan Fabrication Work**

**Section – 1 Background of the project:**

1. National Gallery of Modern Art, Delhi will hold an exhibition entitled Hاستantan to trace the artistic journey of **Nandalal Bose** (3 December 1882 – 16 April 1966), one of the pioneers of modern Indian art and a crucial figure of Contextual Modernism through his 150 artworks from NGMA collection. A disciple of Abanindranath Tagore, Bose was known for his "Indian style" of painting. He became the principal of Kala Bhavan, Santiniketan in 1922. His artistic style had influence of the murals of Ajanta; his classic works include paintings of scenes from Indian mythologies, women, and village life. His paintings are considered among India's most important modern paintings. He occupies a place in the history of Modern Indian art that combines those of Raphael and Durer in the history of the Renaissance. Like Raphael Nandalal was a great synthesizer, his originality lay in his ability to organize discrete ideas drawn from Abanindranath Tagore, Rabindranath Tagore, E. B. Havell, Ananda Coomaraswamy, Okakura Kakuzo and Mahatma Gandhi into a new art movement in India. The exhibition will be opened for public viewing on 26<sup>th</sup> February 2021.

**Section – 2 Objectives:**

In order to provide and ensure proper execution of the exhibition designs as per scenography prepared by NGMA Curatorial and design team NGMA intends to engage an agency to manage the entire fabrication of the exhibition with the scope mentioned in this document.

**Section – 3 Scope of Work:**

Overall scope of work includes: -

- Preparation of exhibition hall as per design and scenography. (Annexure-1)
- Fabrication of exhibition space/installation props (indoor and outdoor). (Annexure- 2)
- Procurement of materials required for fabrication and preparation of exhibition hall.

Interested parties are requested to submit quotations in sealed envelope within 5 (five) days of the publication of this Notice to the following.

**N. N. Dongadi**  
**Administrative Officer**  
**National Gallery of Modern Art**  
**New Delhi**

### CHECK LIST FOR BIDDERS/APPLICANTS

1. The Bidder should ensure that all documents and papers submitted in this BID are fully authenticated by the authorized signatory under his signature with official seal wherever applicable.
2. The following documents form should be submitted with BID:

Sl.No.	Documents to be submitted Documents submitted	Y/N	Documents Submitted
1.	All pages of this BID document should be duly signed by the authorized signatory as a token of acceptance of all terms and conditions by the bidder. Any other document submitted by the bidder should also be signed by the authorized signatory		Pager No. at which Document attached
2.	Signatory indicating experience of supplying such items and working with Govt. Ministries/ Departments / PSUs, etc.		
3.	General Power of attorney in favor of the signatory signing the BID documents. It is not required in case of proprietary firm if the Proprietor himself signs the documents.		
4.	Attested copy of Article or Memorandum of Association or Partnership deed or proprietorship registration as the case may be.		
5.	Attested copy of VAT/CST/Service TAX Registration number, if applicable.		
6.	Attested Copy of PAN/Number.		
7.	Attested copy of return for last month/quarter as the case may be submitted towards Central and State Sales Tax/VAT if applicable.		
8.	Bank Account No. of the firm with IFS code & Bank Branch Name		

Signature of the Bidder

## **TERMS AND CONDITION**

### **01. Delivery Place:**

Bidder will supply and deliver the materials in requisite number at the office of “**National Gallery of Modern Art, Delhi**”

### **02. Qualification Conditions:**

- a) Bidder should be registered establishment and should be authorized supplier/ service provider of the quoted item/ work and should submit the relevant documents/certificates.
- b) Bidder should have experience of supplying such items and will have to furnish details of previous supplies.
- c) Bidder shall provide all relevant records required i.e. Income Tax Return Certificate/PAN, Commercial Tax Clearance/V.A.T. Certificate And other taxes (whichever applied)

### **03. Bid price:**

- a) The contract shall be for a period of three months.
- b) The rates quoted by the bidder shall be fixed for the duration of the contract and shall not be subject to adjustment of any account.
- c) All duties, taxes and other levies including the transportation expenses are payable by the Supplier/Agencies/Company under the contract and shall be included in total price.

### **04. Submission of Quotations/Bid:**

1. Establishment Registration Certificate
  2. Current Return of Income Tax.
  3. Commercial Tax clearance Certificate
  4. Bid Security as stipulated in the bid document.
  5. Details of Work Experience.
- a) The Financial part (Part – II) of the bid shall consist of only Rate/Price in Proforma supplied with the IFQ on the company's / Firm's letter pad. All the column and requisite information must be filled in the prescribed format. Bidder must quote the item wise.
  - b) Award of contract on the basis of lowest evaluated price for which the bidder must quote the rate per item. Bidder must quote the rate of all items.

### **05. Performance Security:**

- a) 5% of total bid/contract value will have to be deposited as performance security in form of Bank Guarantee/ Demand Draft in favor of **DDO, National Gallery of Modern Art, Delhi**. By the lowest evaluated responsive bidder before the award of work. The performance security will be refunded only after the expiry of the contract as specified in the bid document/agreement.

- b) The performance security deposit shall be forfeited in case of any terms and conditions of the contract/agreement etc. infringed or the bidder fails to complete the supply in time.

**06. Validity Quotation:**

Quotation shall remain valid for a period not less than 90 days after the deadline date specified for submission.

**07. Evaluation of Quotation:**

The purchaser will evaluate and compare quotations determined to be substantially responsive i.e.

- a) Are properly signed
- b) Confirm of terms, conditions, specifications and qualifications conditions.

**08. Award of Contract:**

The purchaser will award the contract to the bidder whose quotations has been determined to be substantially responsive, and who has offered the lowest evaluated quoted price.

8.1 Notwithstanding the above, the purchaser reserves the right to accept or reject any quotations and to cancel the bidding process and reject all quotations at any time prior to the award of the contract.

8.2 The bidder whose bid is accepted will be notified of the award of contract by the purchaser. The terms of the accepted offer shall be incorporated in the supply order. The validity period May be extended by the purchaser by another 15 day in exceptional cases.

**09. Other Terms and Conditions:**

- a) The NGMA reserves the right to preponed /postponed/cancelled the bid, the bidder will have to abide with the decision.
- b) Payment shall be made after the supply and submission of bills which will be subject to satisfactory supply (certified by the committee constituted for the purpose). Personnel In charge will certify the quality and quantity of the items supplied/work done as per specifications and recommend accordingly the extent of payment.
- c) Quotation may be submitted on the printed letter head of the bidder in the prescribed format supplied with IFQ.
- d) No payment will be made for any damage of goods supplied.
- e) Liquidated damages provisions for damages shall be included of the contract when delays in delivery of goods, completion of work or failure of the goods or work to meet performance requirements would result in extra cost, or loss of revenue or loss of other benefits to the implementing agency.

Sealed quotations received till then will be opened in the office **2.02.2021 at 3:00 PM.**

We look forward to receiving your quotations and thank you for your interest in this project.

# हस्तान्तरण transmission

nandalal bose  
NGMA NEW DELHI

## spatial grouping of exhibits

### 1. TISTAR PORTRAIT

#### 2. GANGA AVATARAN

story: A new wave in Indian Art descending from traditional Indian moores with unprecedented force and landing midst the hegemony of colonial/ European artistic practice.

#### 3. EXHIBITION BRANDING

and Introductory Note

### 4. JERK ROOM

story: The Acharya and his students

### 5. RAM STUDIES

#### 6. SUMI-E PRACTICE CARDS

story: Sino-Japanese influence

#### 7. HARIPURA POSTERS

story: Nandalal's place within the nationalist movement

### 8. HANTAR/ Transmission

ory:sStanghamitra

### 9. RAM STUDIES

ory:sMythological Narratives with distinctly Indian values and characters  
(ref - Kriti Mandir Commission)

### 10. COLLAGES & LINOCUTS

ory:st Hela Phalar Kaaj

### 11. DUNDESA/ ANTINIKETAN

#### 12. NATURE

ory:sntew landscapes in one's backyard — a rediscovery

#### 13. MYTHOLOGY

ory:sSpiritual Leanings

#### 14. INDRAPRASTHA - MAHABHARATA MURAL STUDIES



## spatial grouping of exhibits | internal gallery architecture



1 scroll banner artist's portrait  
vas print: 5ft 6in x 12ft

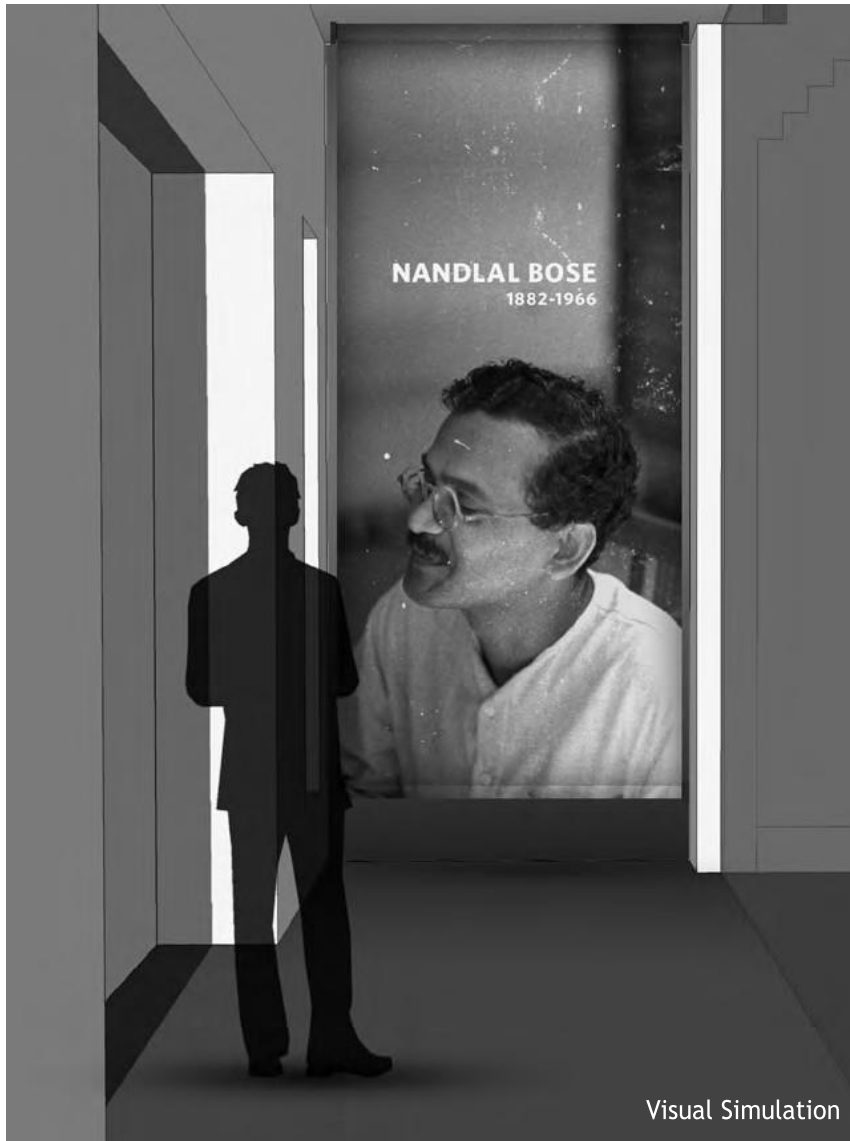

Visual Simulation



Reference Images





## 2 door ganga avataran

story: A new wave in Indian Art descending from traditional Indian moores with unprecedented force and landing midst the hegemony of colonial/ European art practice.



## 2 door ganga avataran

story: A new wave in Indian Art descending from traditional Indian moores with unprecedented force and landing midst the hegemony of colonial/ European art practice.

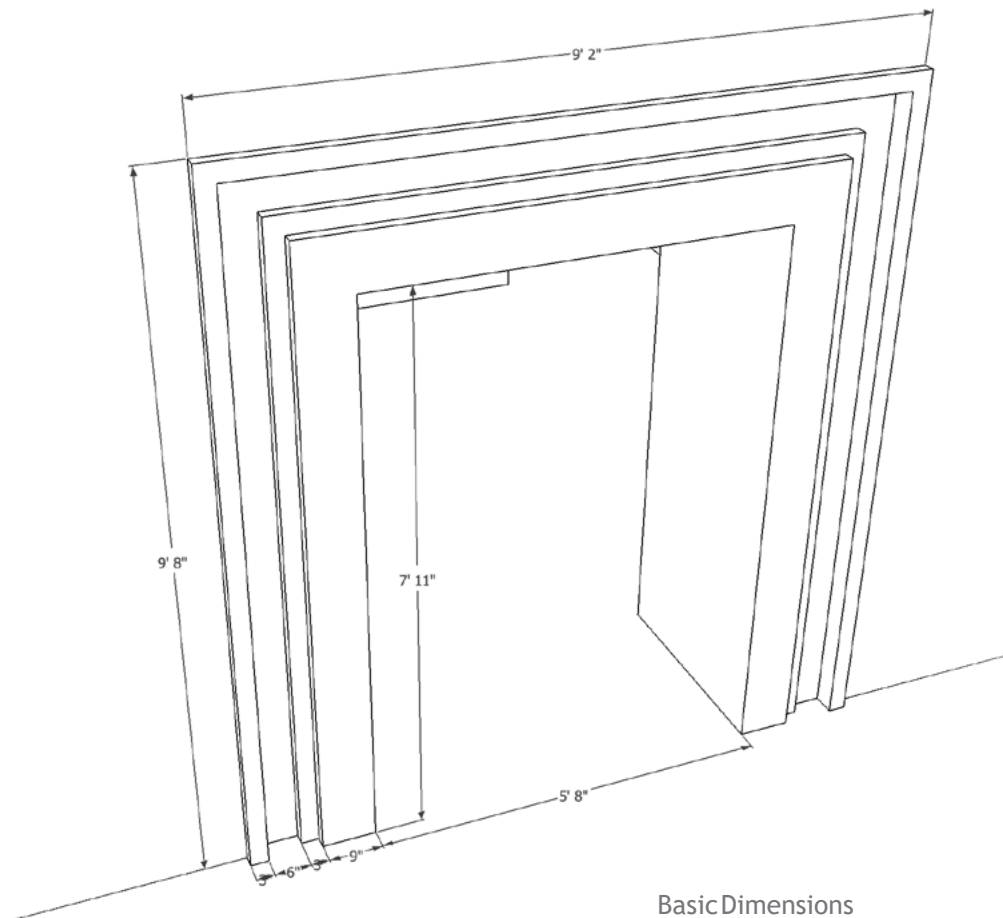

Reference Image



### 3 stamp exhibition branding

story: Nandalal's iconic stature on the national canvas of his time for his contribution in seeking a modern Indian identity.



## 4 video room



## 5 mural studies



## 6.1 tree-pillar sumi-e practice cards

story: Sino-Japanese influence and Nandalal's ever-ready ability to respond to environmental stimuli.



Visual Simulation

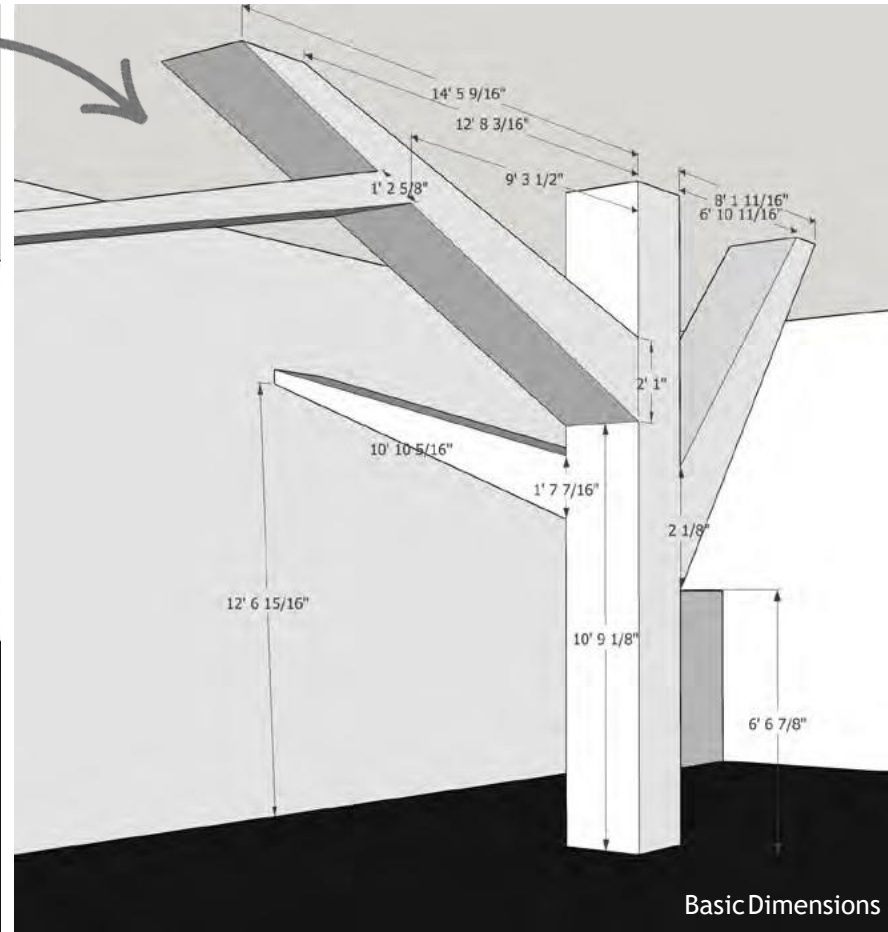

Basic Dimensions

## 6.2 base plinth sumi-e practice cards

story: Sino-Japanese influence and Nandalal's ever-ready ability to respond to environmental stimuli.

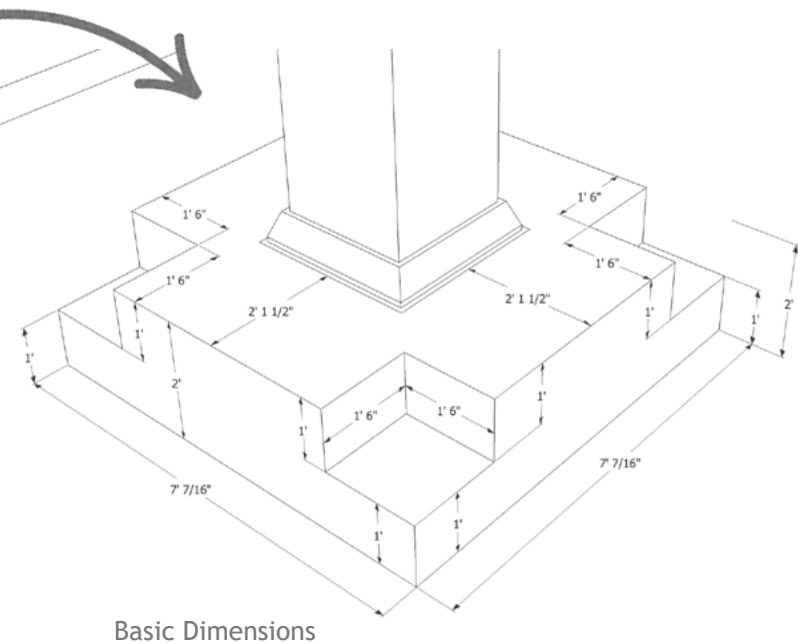
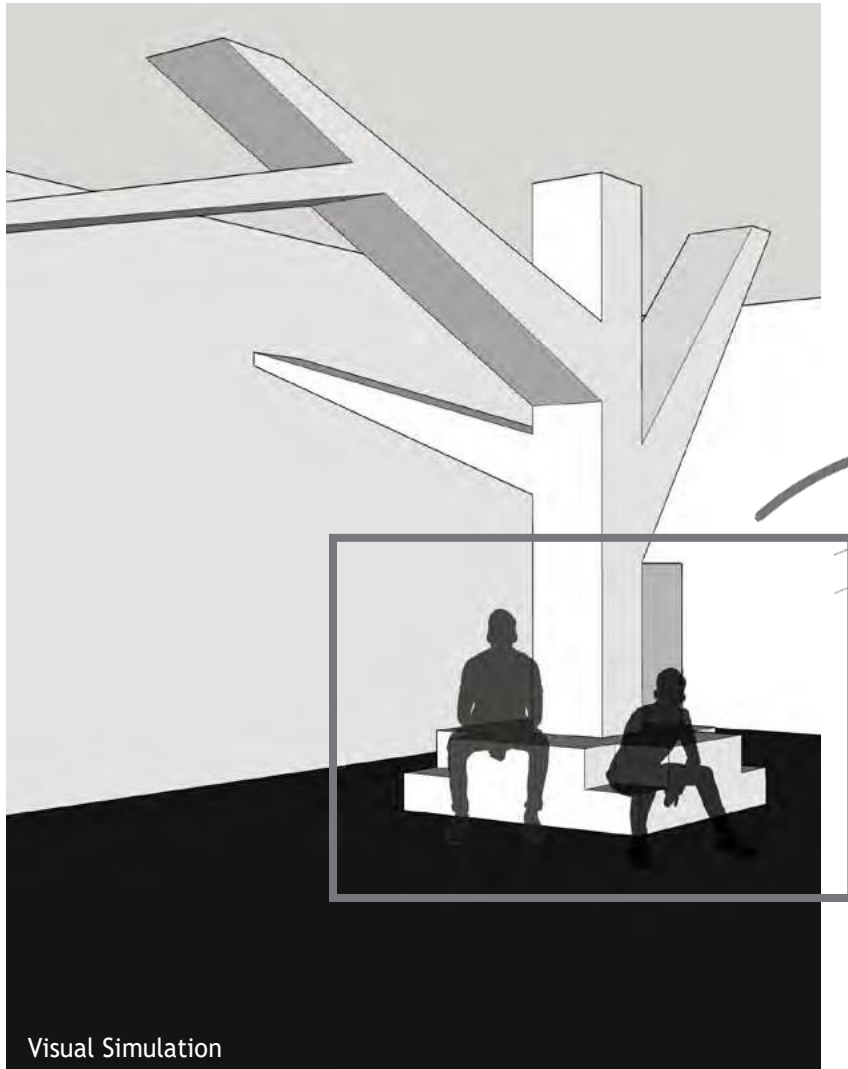

## 7.1 frames haripura posters

story: Nandalal involvement in the nationalist movement



Visual Simulation



## 7.1 frames haripura posters

story: Nandalal involvement in the nationalist movement

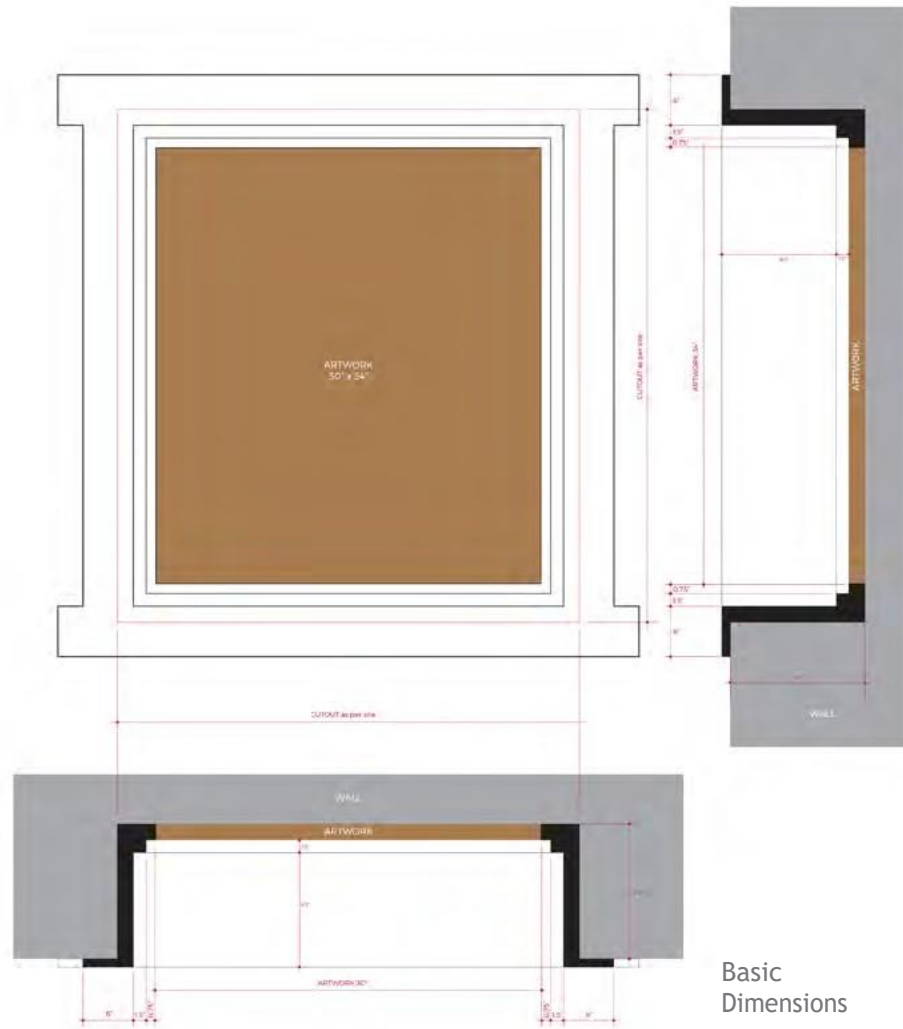

Basic Dimensions

Visual Simulation

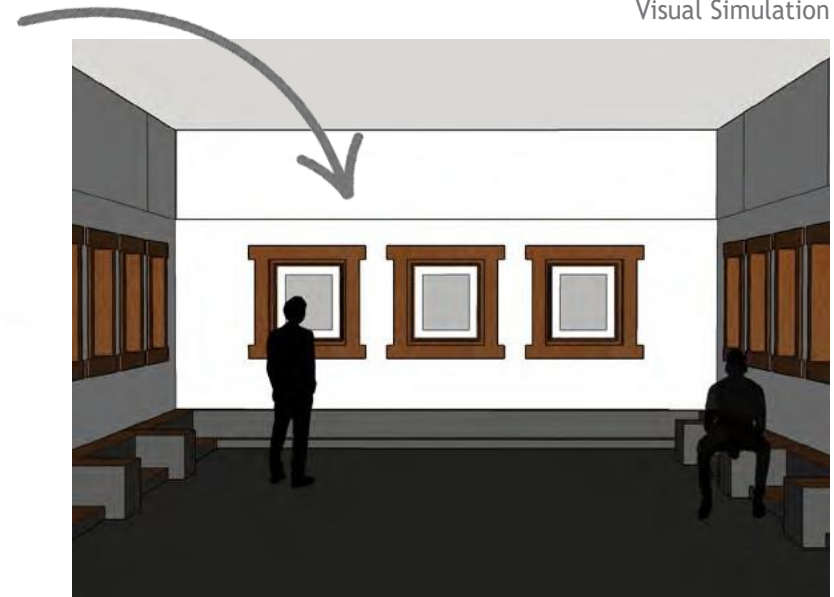

## 7.2 plinth haripura posters

story: Nandalal involvement in the nationalist movement

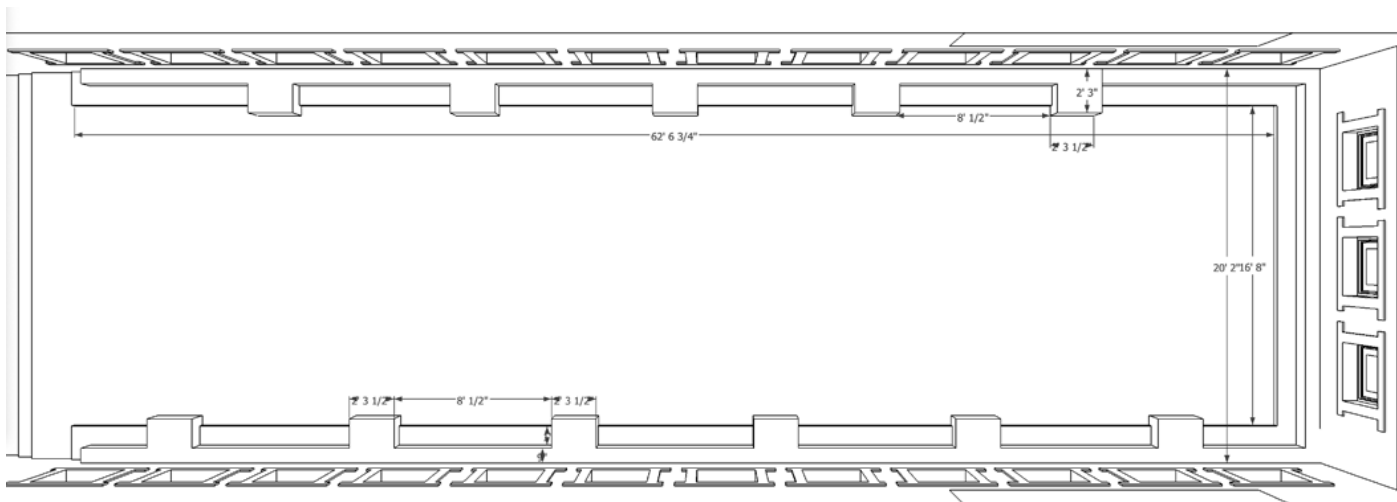

## 7.3 light box haripuraposters

story: Nandalal involvement in the nationalist movement



Visual Simulation

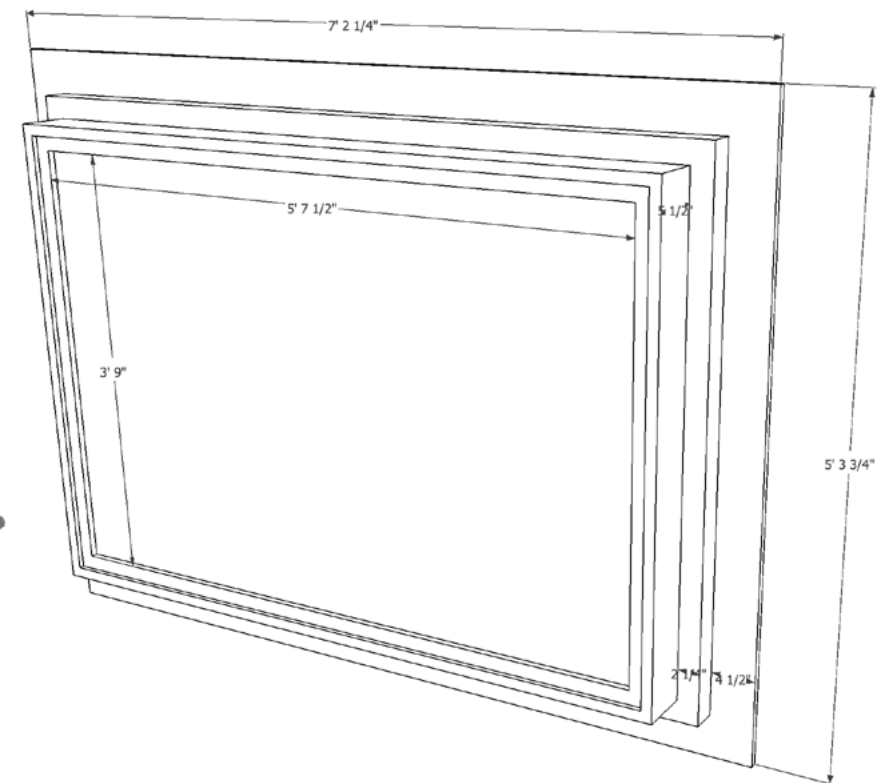

Basic Dimensions

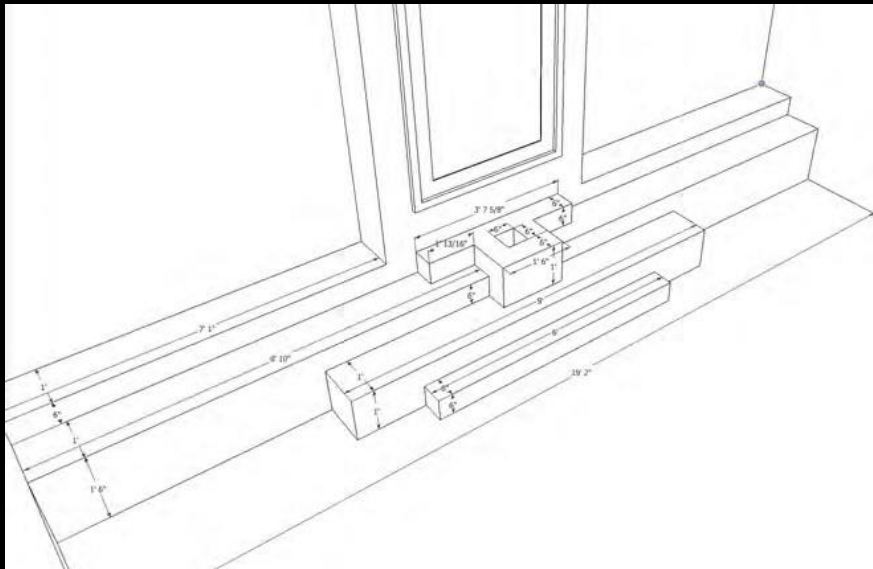

A 3D perspective rendering of a wooden structure, possibly a door or a large box, with a yellow rectangular panel in the center. The structure is composed of several horizontal and vertical wooden planks. The background is a light gray wall and floor, with a dark gray floor area visible in the foreground.

NANDALAL BOSE | NGMA

# 9

## mural studies

story: Mythological Narratives with distinctly Indian values and characters  
(ref - Kriti Mandir Commission)



# 10 wall extension COLLAGES & LINOCUTS story:



Visual Simulation

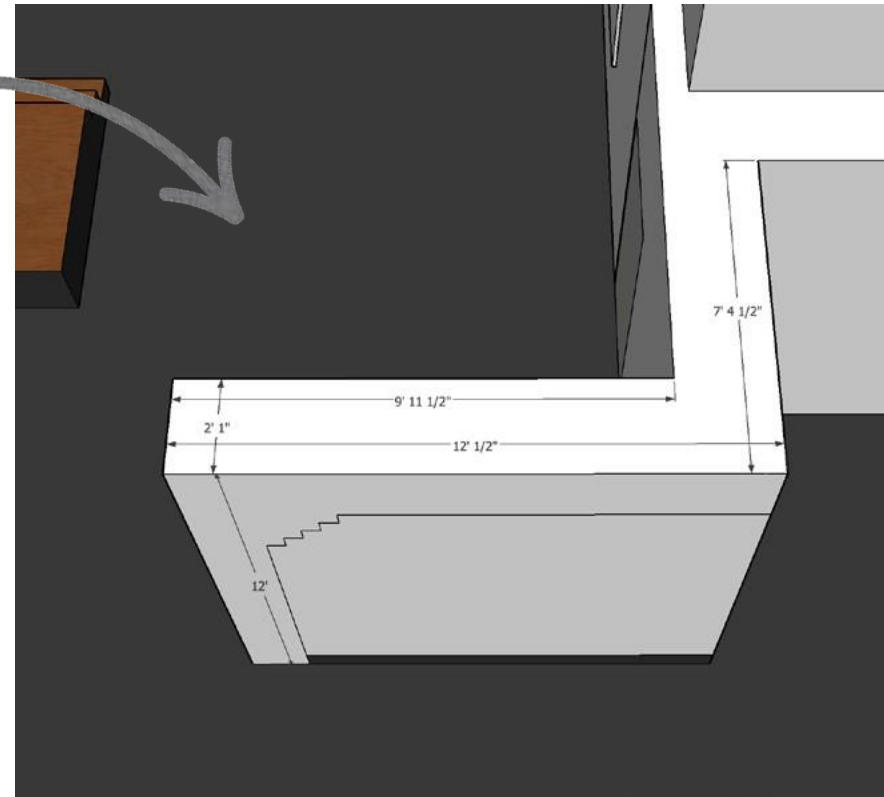

Basic Dimensions

## 11.1 wall extension LIFE AROUND SHANTINIKETAN

story:



Visual Simulation

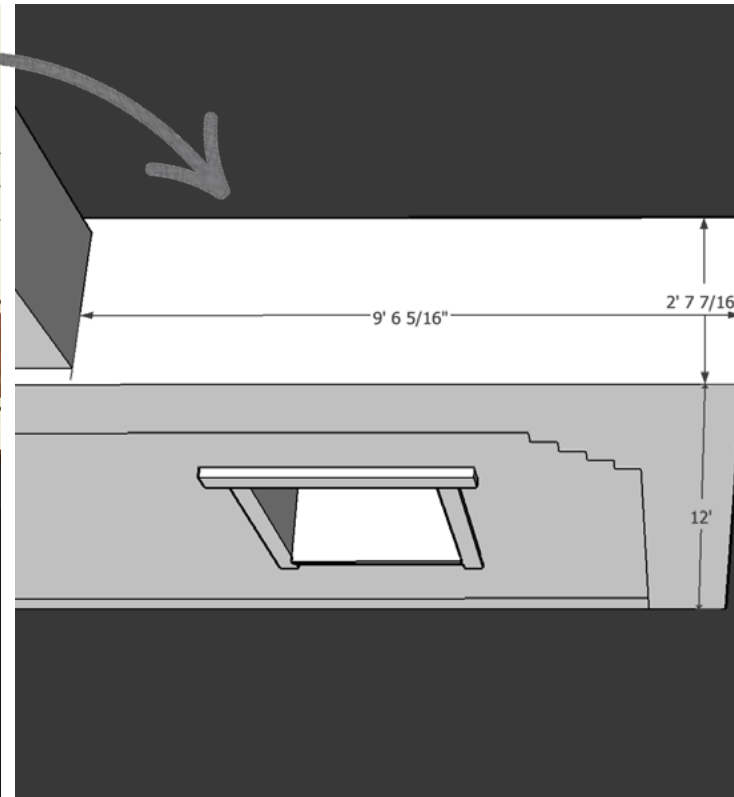

Basic Dimensions

## 11.2 window LIFE AROUND SHANTINIKETAN story:



Visual Simulation

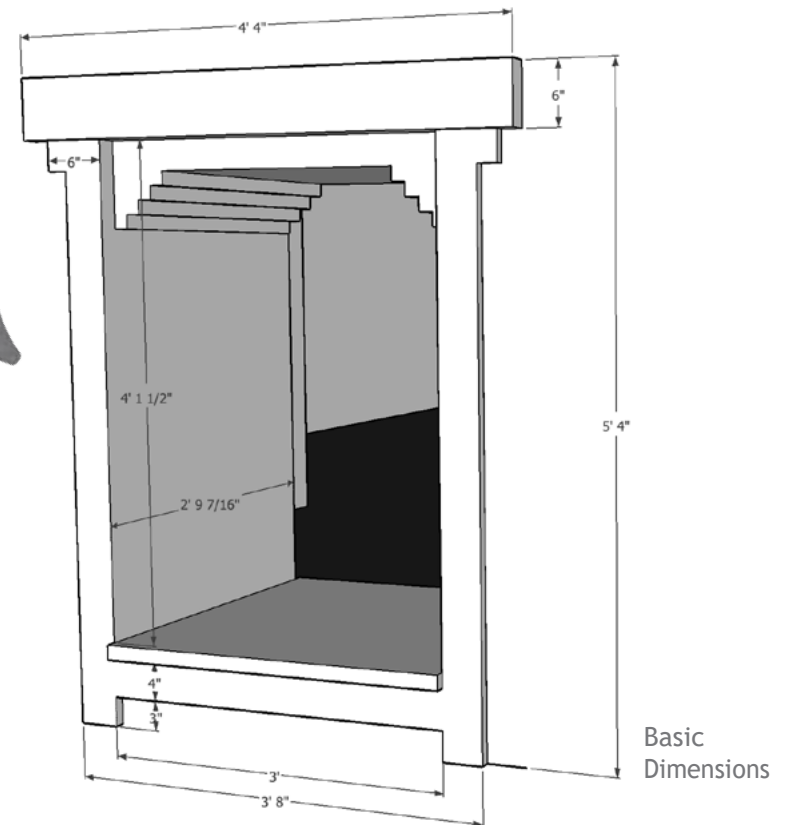



12

## nature

story: New landscapes in one's backyard — a rediscovery



13

## mythology

story: Spiritual learnings



# 14 indraprastha | mahabharata mural studies story: ?



Visual Simulation

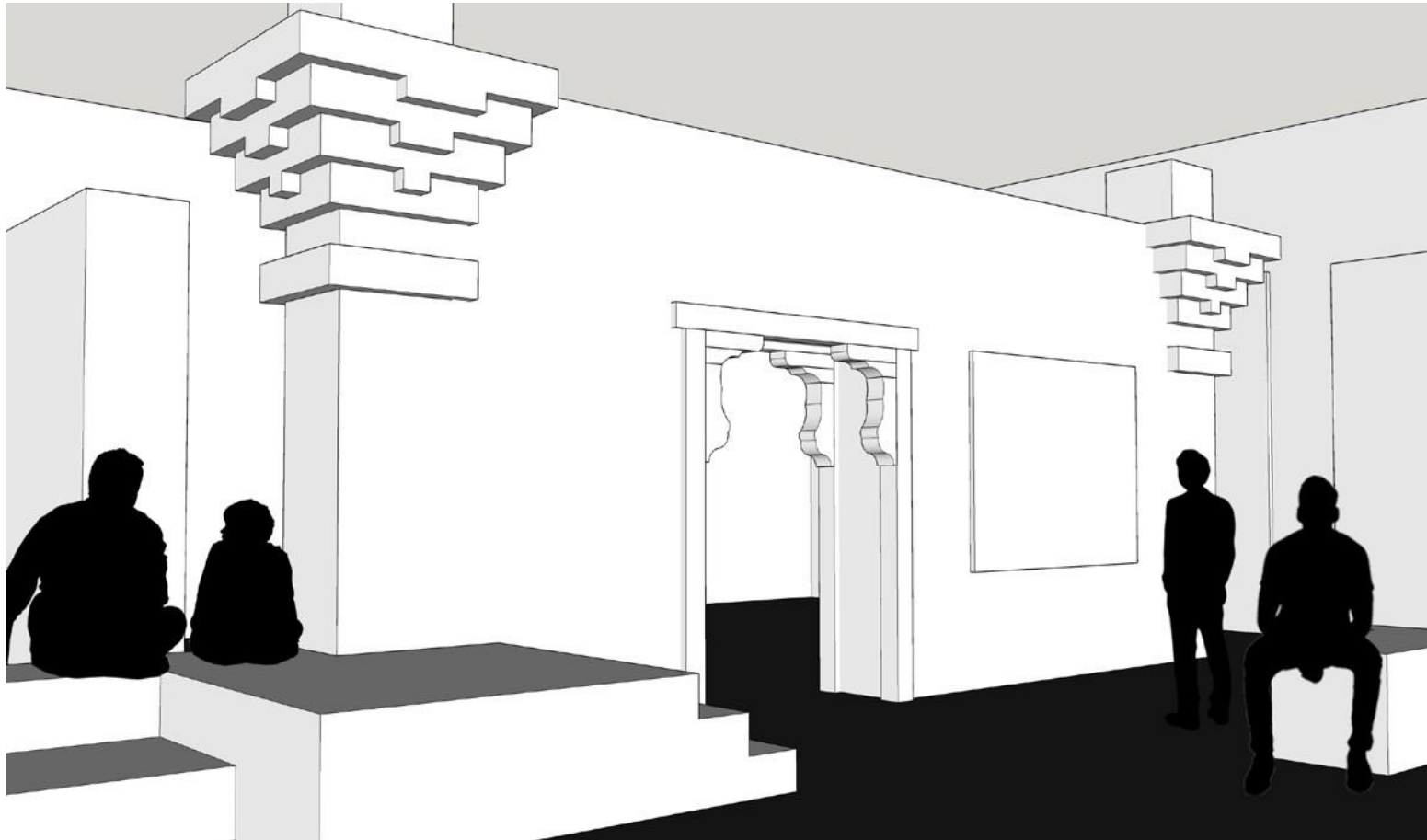

# 14.1 doorway indraprastha | mahabharata mural studies

story: ?

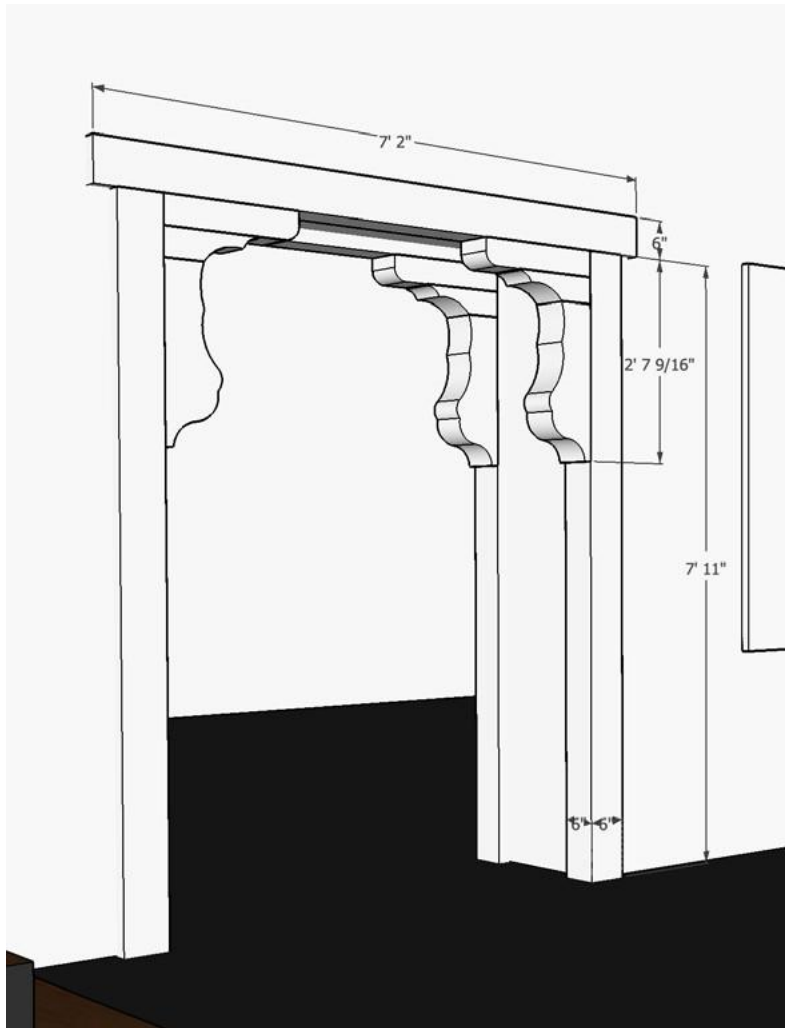

Basic Dimensions

Reference Image

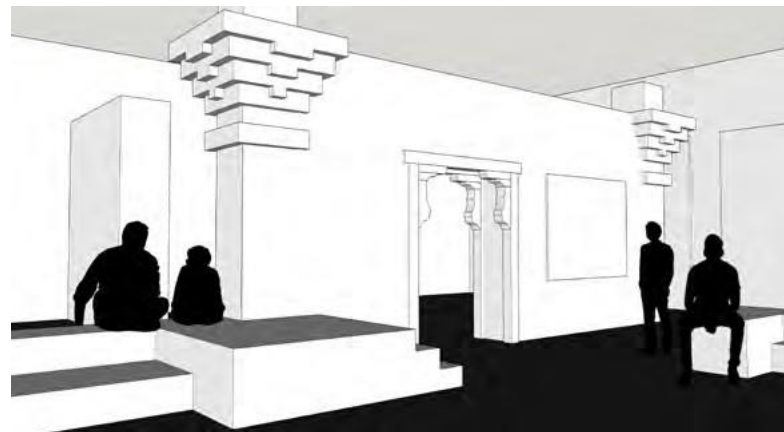

Visual Simulation

## 14.2 pillar capital indraprastha | mahabharata mural studies

story: ?



Basic Dimensions

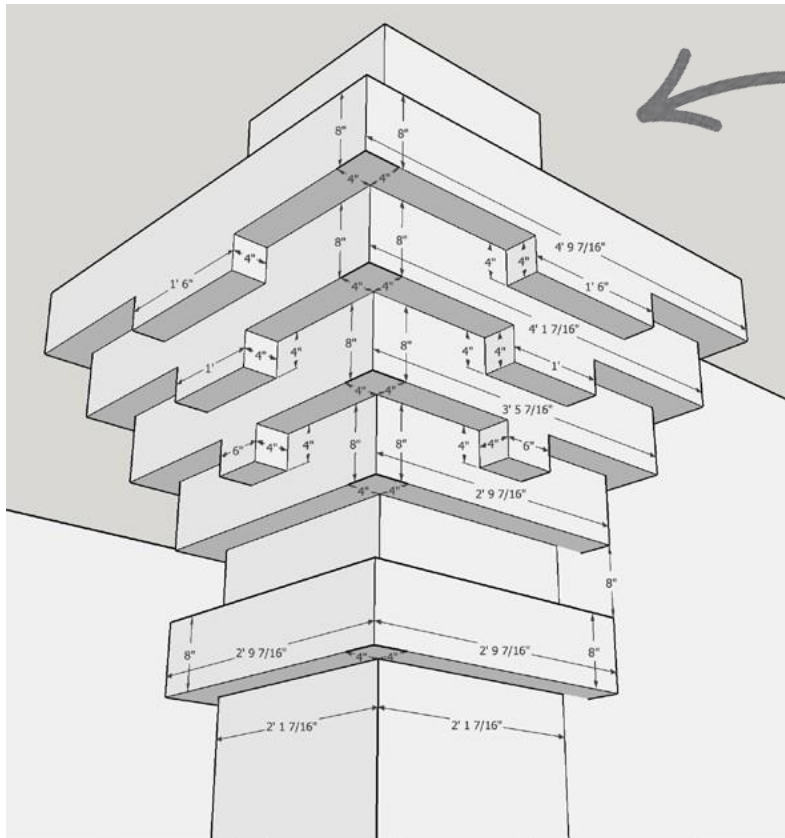

Visual Simulation

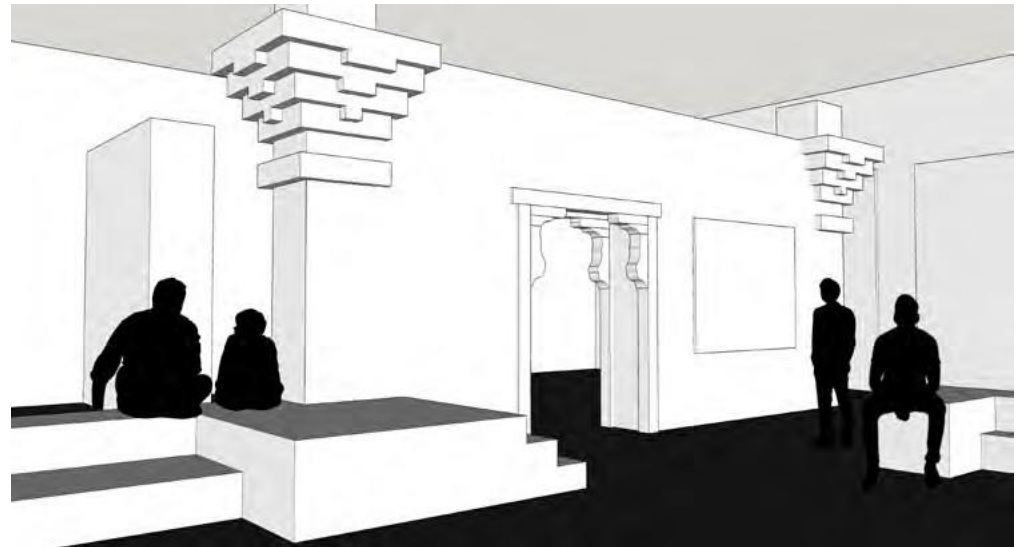

14.3 plinth 1 indraprastha | mahabharata mural studies  
story: ?



## Visual Simulation

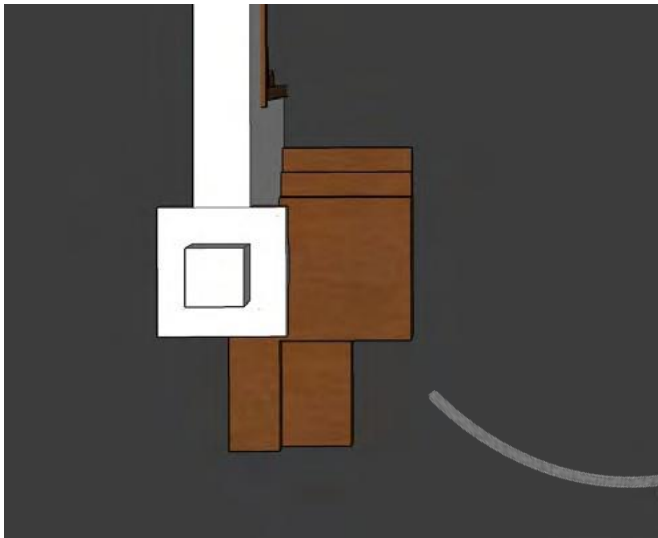
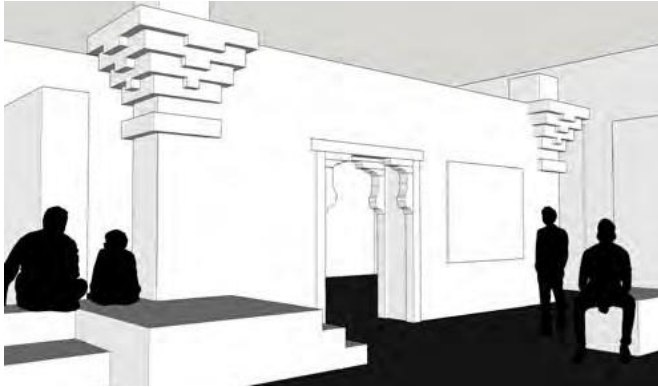

Top View

## Basic Dimensions

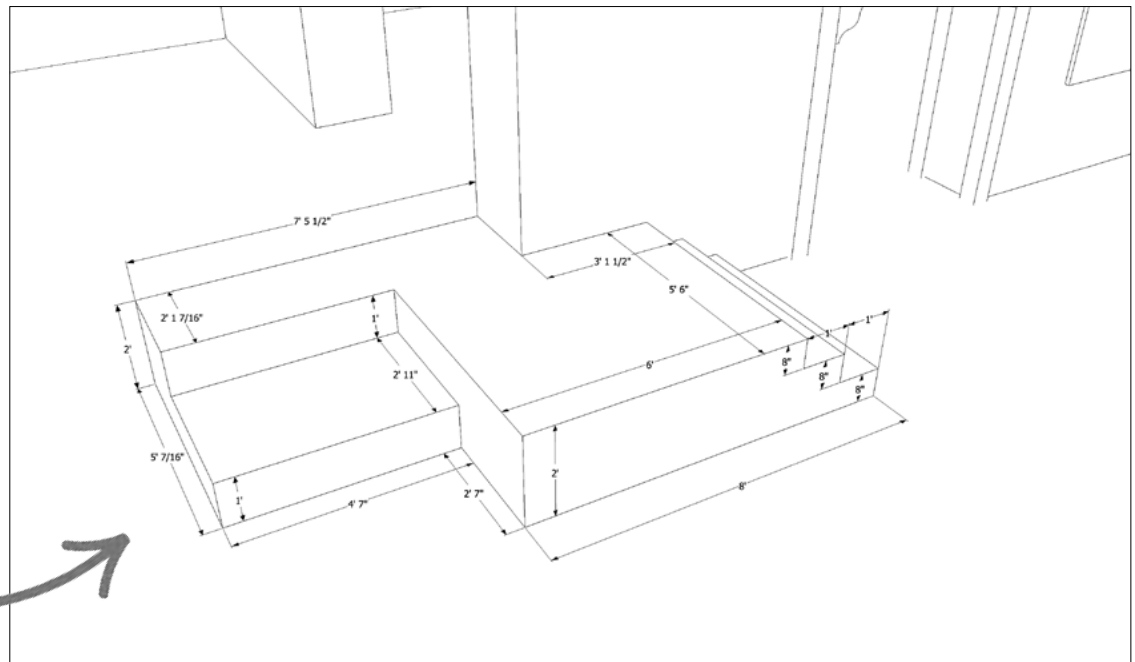

## graphic palette | colour

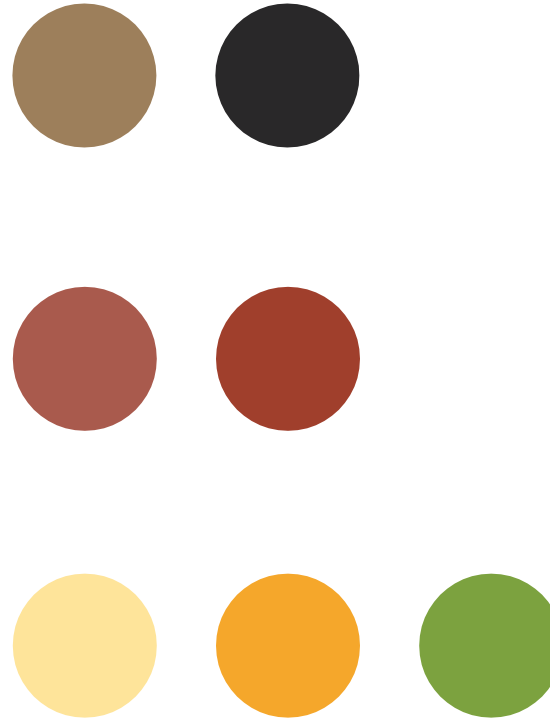
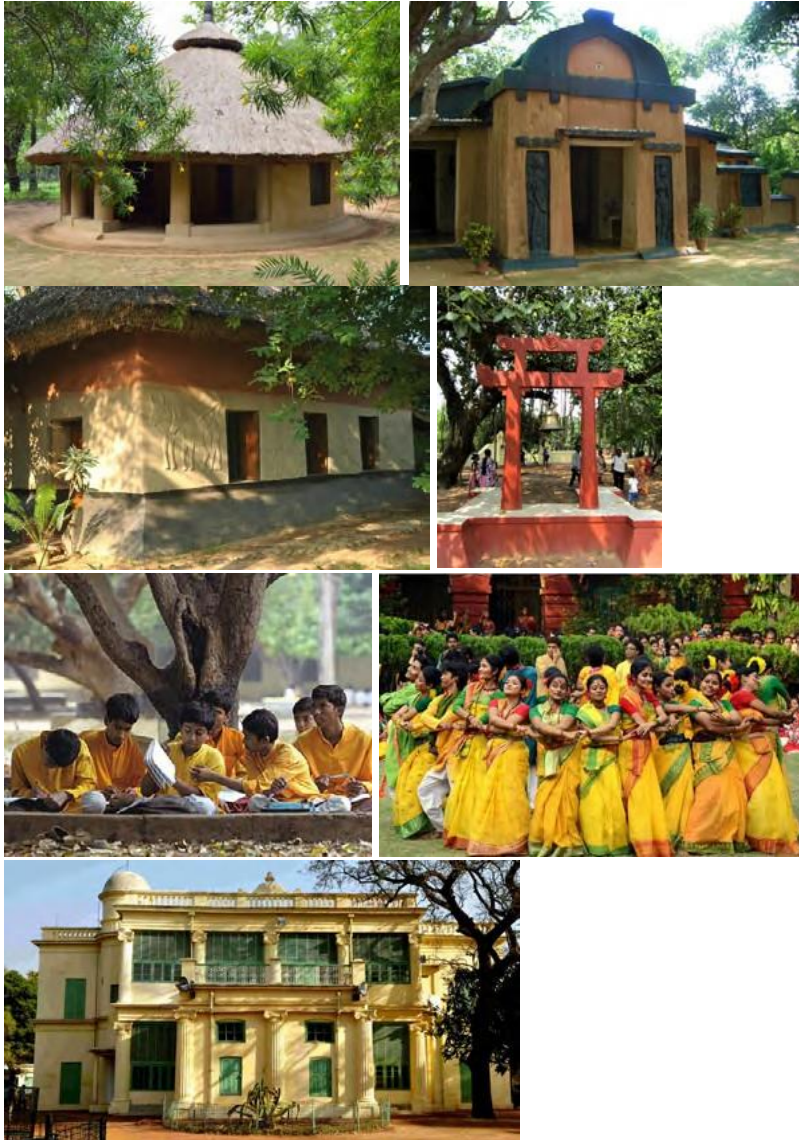



referencing on-campus architecture at Shantiniketan: THE STEPPED CORNER





## graphic palette | form

referencing on-campus architecture at Shantiniketan: THE STEPPED CORNER

Udayan/ Konark



## NANDALAL BOSE | NGMA

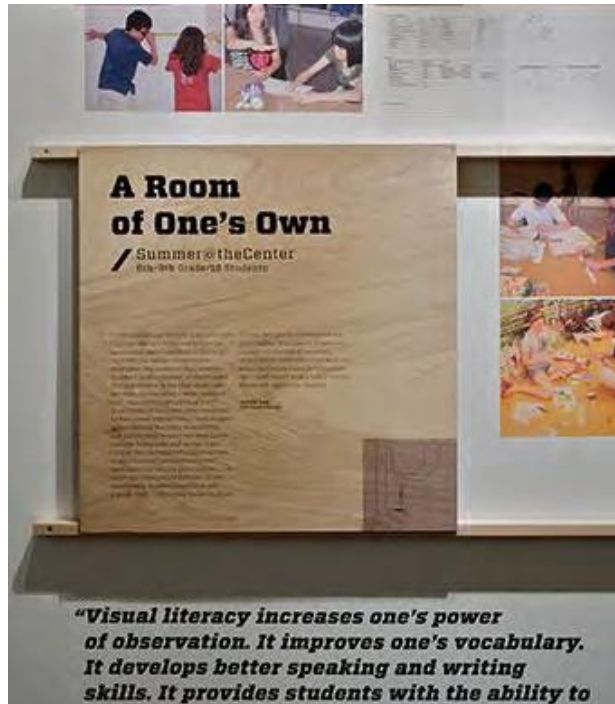

## Annexure - 2

No	Item	Image	Size	Quantity	Specification
1	Scroll Banner		5'6" x 12'	1	Digital Print on Canvas with loops on top and bottom with rods and end bobs
2	Door with Moulding		9'2" x 9'8	1	Doorway with moulding
3	Stamp		4' x 3'	1	Digital Print of postal stamp on MDF. Edges cut like a postall stamp
4	Dark Room			1	Painted (charcoal gray) room - Text transfers on 3 walls + video projection on wall
5	Murals			1	Painted (mud colour) wall - Text transfers + Paintings
6.1	Tree Pillar		Pillar Dimensions 25" x 25"  For Branches, please refer to the drawing		Tree branches to be fabricated as shown in the drawing and attacehd to existing pillar. This will be finished in white like a monolithic structure. Metal armature + Board cladding.
6.2	Base Plinth		7'6" x 7'6" x 2'	2	The tops of the Plinth will be wood finished board with the sitting corners with rounded wood. The vertical surfaces will be finished in paint, matched with the colour of the floor).

7.1	Haripura Panels		52.5" x 50.5" (Depth - 10.5")	27	Wood Frames (like a window) with inset painting. This will have to be fitted into niches in the existing wall. Niches will have to be cut.
7.2	Haripura Plinth		Running length - 150'  Cross section - 27" x 16"	1	Plinth running along the length of wall. The top of the Plinth will be wood finished board with the sitting corners with rounded wood. The vertical surfaces will be finished in paint, matched with the colour of the floor).
7.3	Light box		86" x 63"	1	Light Box with digitally printed image on cloth and framed in wooden box with moulding as shown in the image.
8	Sanghamitra Wall + Plinth		Wall 13' x 5'  Plinth 19'2" x 2' (42" Depth)	1	Wall emerging from the plinth. Please refer to the image for details. Multiple stepped plinth with puncture for a potted plant. The top of the Plinth will be wood finished board with the sitting corners with rounded wood. The vertical surfaces will be finished in paint, matched with the colour of the floor).
9	Kirti Mandir Story				Not Applicable
10	Wall Extension		Running Length 19'4" x 2'1"  12' (Height)	1	An L-Shaped wall extension. Please refer to the drawing for dimensions.

11.1	Wall Extension		9'6" x 2'7" 12' (Height)	1	A wall extension to an existing wall with a window cut into the wall.
11.2	Window		4'4" x 5'4" 2'9" (Depth)	1	A window constructed as per the drawing with rough primer/putty to give it a "lime plaster" like finish. This will be painted in the colour of the wall.
12	Nature				Not Applicable
13	hela-fela				Not Applicable
14.1	Indraprastha Doorway		As per Drawing	2	A set two [Pillar(2) + Brackets (2) + Beam(1)]. Constructed preferable in wood. inserted in the cutout in the wall on either side of the wall opening. This will constructed as per the drawing with rough primer/putty to give it a "lime plaster" like finish. This will be painted in the colour of the wall.
14.2	Indraprastha Pillar Capital		As per Drawing Approx 4'9" x 4'9" 4' Height	2	A set of two pillar capitals. Constructed preferable in board and installed on the two existing pillars. This will constructed as per the drawing with rough primer/putty to give it a "lime plaster" like finish. This will be painted in the colour of the wall.
14.3	Indraprastha Plinth 1		As per Drawing Approx 12'7" x 7'7" 2' Height	1	The tops of the Plinth will be wood finished board with the sitting corners with rounded wood. The vertical surfaces will be finished in paint, matched with the colour of the floor).

14.4	Plinth 2		As per Drawing Approx 4' x 2' 2' Height	8	The tops of the Plinth will be wood finished board with the sitting corners with rounded wood. The vertical surfaces will be finished in paint, matched with the colour of the floor).
------	----------	--	---	---	--

Labour for setup and dismantling on site. Transportation for setup and dismantling

No	Item	Image	Size	Quantity	Specification
1	Wall Paint		As per discussion	All wall surfaces	Area to be masked and painted as per discussion and design. Paint colour and texture will be assigned at site during execution. Walls will not be painted beyond 10 feet.

PRINT					
No	Item	Image	Size	Quantity	Specification
1	Digital Prints	NA	3' x 4'	28	Digital Prints on vinyl. Matte Lamination. Pasted on 8mm BLACK sunboard
2	Artwork Labels (MDF) OPTION 1	NA	6"x4"	430	Digital Print on 6mm MDF (light coloured)
3	Artwork Labels (Cement Board) OPTION 2	NA	6"x4"	430	Digital Print on 6mm Cement Board
4	Text Transfers	NA	3' x 4'	28	Vinyl text transfers.
5	Canvas Banners	NA	6' x 24'	7	Digital Print on Canvas with loops on top and bottom with rods and end bobs
6	Directional Signage	NA	6' x 3'	5	Digital Print on Canvas mounted on frames with floor stands
7	Road Side Banner	NA	15' x 8'	2	Digital Print on Canvas mounted on frames

